



Water Claw Flood Tools

Whether you pull the pad or you don't, the first step to making any flood job easier, faster, and more profitable is to start with sub-surface extraction using the Water Claw. Proven on thousands of flood restorations worldwide. Water Claw Flood Extractors are a "must have" tool for the full-service professional.

Water Claw Added Features:

- Vacuum Release. Spring loaded handle automatically breaks vacuum between the carpet and tool for easier and faster flood extraction.
- Telescoping handle easily adjusts for different operators.
- Improved bottom plate for better sub-surface extraction.
- Angled metal hose flange for greater durability accepts 1.5" or 2" hose cuffs.

Unconditional Guarantee

Hydro-Force now offers a 30-day guarantee on the purchase of your first Water Claw Sub-Surface Spot Lifter or Flood Extractor. If you don't agree that sub-surface extraction performed by the Water Claw will be an important part of your business, return it for a full unconditional refund.

Medium
10" x 17" Extracts about 800 sq. ft. per hour
#AC016

Large Unit 12" x 21"
Extracts about 1200 sq. ft. per hour
#AC018



Water Claw Spot Lifter



#AC012

A spotting revolution has begun!

If the problem is in the carpet backing or pad, the solution is a Water Claw Sub-Surface Spot Lifter. Flush out urine contamination, soda pop, oils, soap residues, food spills, etc. completely. Use with a truckmount, portable, or mini-extractor. Accepts 1.5" or 2" hose cuffs.

Incredible results! Amazingly simple!

Try is once and you'll wonder how you ever got along without one!

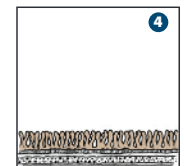
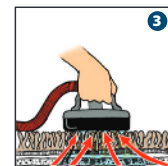
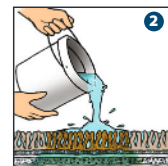
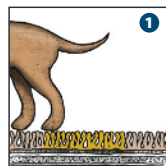

Available at a retailer near your you. Learn more at www.hydroforce.com

